

murphy beds

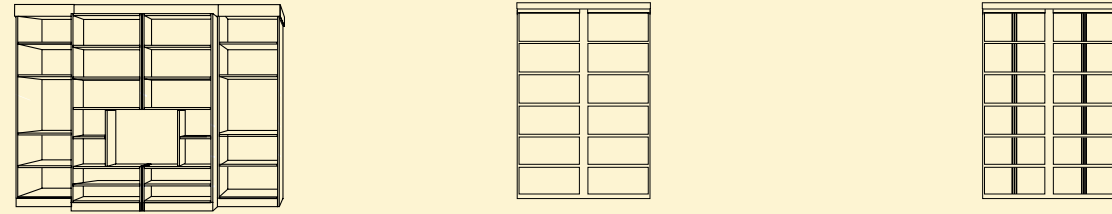

	jefferson library bed	madison bookcase bed	madison bi-fold bookcase bed
--	-----------------------	----------------------	------------------------------

	Presidential indeed, with ample storage for books or collectibles. The bookcase doors effortlessly glide open on sturdy tracks.	Stylish bookcase or cozy sleeper? It's both. Swing open the shelved doors to reveal the pull down bed inside!	Unique. Similar in look to the Madison. Bi-folding doors take up less wall space when open.
style	murphy bed	murphy bed	murphy bed
doors	tracked shelved doors	hinged shelved doors	hinged shelved doors
cabinets	30" side cabinets included	side cabinets optional	side cabinets optional
mattress	8 or 12 inches	8 or 12 inches	8 or 12 inches

dimensions & bed projection (bp): The space from the support wall that the mattress, panels or foundation projects into the room.

twin	-	45"w x 23-1/8"d x 85"h : 81" or 86"bp 86-1/2"w with doors open	-
twin long	-	45"w x 23-1/8"d x 90"h : 86" or 91"bp 86-1/2"w with doors open	-
full	121-3/4"w x 23-1/4"d x 87-5/8"h : 81"bp 121-3/4"w x 28-1/4"d x 87-5/8"h : 86"bp	60"w x 23-1/8"d x 85"h : 81"bp 60"w x 28-1/8"d x 85"h : 86"bp 117"w with doors open	60"w x 23-1/8"d x 85"h : 81"bp 60"w x 28-1/8"d x 85"h : 86"bp 88"w with doors open
queen	127-1/2"w x 15"d x 92 5/8"h: 86"bp 127-1/2"w x 20"d x 92 5/8"h: 91"bp	66"w x 23-1/8"d x 90"h : 86"bp 66"w x 28-1/8"d x 90"h : 91"bp 123"w with doors open	66"w x 23-1/8"d x 90"h : 86"bp 66"w x 28-1/8"d x 90"h : 91"bp 97"w with doors open
king	-	-	-

madison bookcase bed door options:

Choose from swinging doors or bi-fold doors to suit your space.

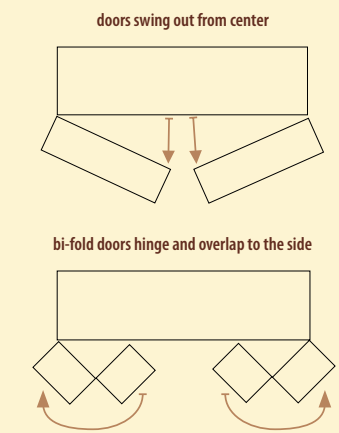

Madison Bi-fold Bookcase Bed (pictured with side cabinets)



Madison Bi-fold Bookcase Bed (pictured open with side cabinets)

endless options

Customize your Murphy bed with these functional cabinet units in any of hundreds of style and finish combinations. Available in 85" or 90" heights, 12", 15", 20" or 24" depths, and 15", 24", 30" or 36" widths.

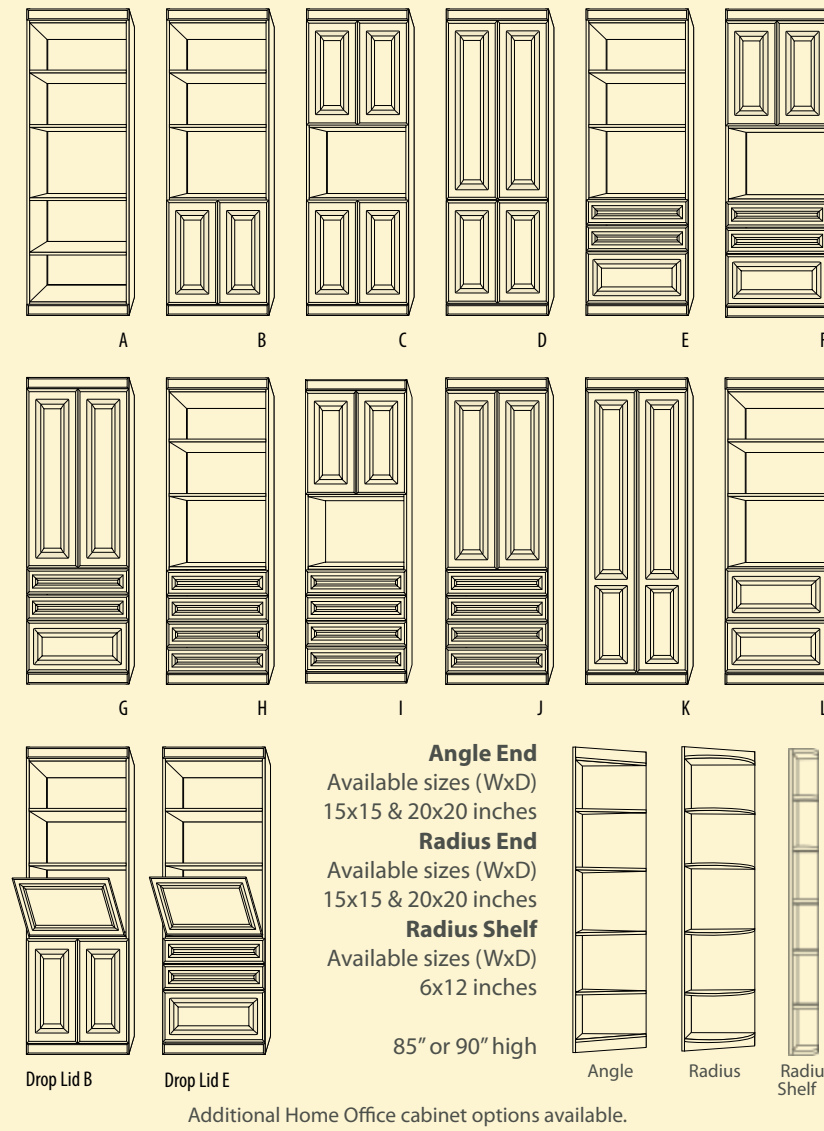

Angle End
Available sizes (WxD)
15x15 & 20x20 inches

Radius End
Available sizes (WxD)
15x15 & 20x20 inches

Radius Shelf
Available sizes (WxD)
6x12 inches

85" or 90" high

Angle Radius Radius Shelf



Panel Bed with Home Office



Murphy Bed with Home Office

Rest assured our Serta® mattresses - specifically designed for vertical storage and manufactured for More Space Place - represent the pinnacle in sleepy-time bliss. Options range from firm, plush euro-top, to cool action™ gel memory foam.

Enhance your design with Accent and Function LED lighting, available in a variety of styles and light tones.



Schedule a complimentary consultation today.

Visit us online to find a showroom near you: www.morespaceplace.com

At More Space Place, we can uniquely customize and organize any space:

- | | |
|-----------------------|---------------------------|
| In your home... | Commercial Environment... |
| • Closets | • Hotels |
| • Home Offices | • Firehouses |
| • Garages | • Sleep Centers |
| • Pantries | • Dormitories |
| • Laundry Rooms | • Offices |
| • Mud & Utility Rooms | • Medical Offices |
| • Children's Rooms | • Supply Rooms |
| • Multi-Purpose Rooms | |
| • Storage Areas | |

Ask for a More Space Place Home Office and Custom Cabinetry Guide... for more information on our customizable space saving solutions and unbeatable selection.

BP62010PK - 11-2014

© 2014 More Space Place. National network of independently owned and operated franchises.

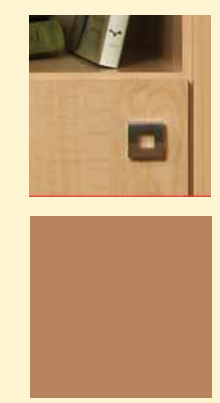
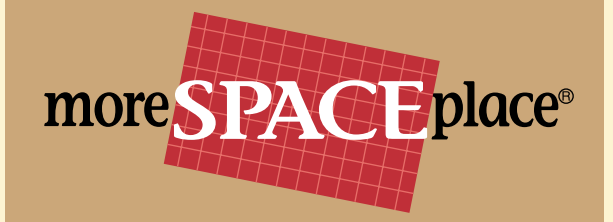

murphy bed • panel bed planning guide

from comfortable bed to stylish space saver in one easy step

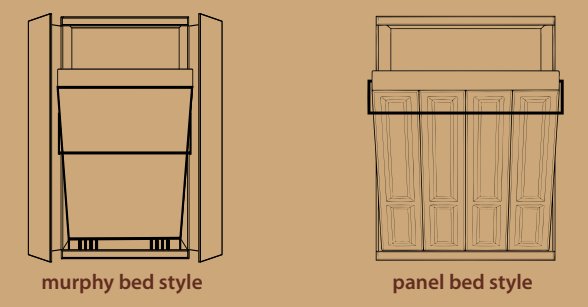

murphy beds

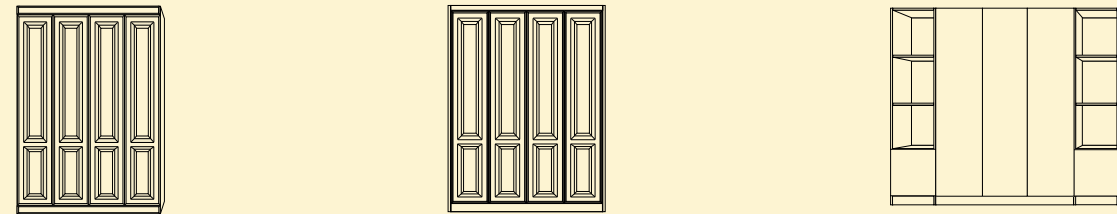

	murphy	pocket door bed	dream saver
	This pull-down bed is hidden by attractive bi-fold doors when not in use. Custom designed for your space and style.	The time-tested Murphy bed mechanism with attractive hide-away bi-fold pocket doors that collapse into the bed cabinet sides.	Stylish and affordable. This Murphy bed – equipped with included functional side cabinets – turns any area into a space savvy guest room.
style	murphy bed	murphy bed	murphy bed
doors	bi-fold doors	bi-fold pocket doors	bi-fold doors
cabinets	side cabinets optional	side cabinets optional	–
mattress	8 or 12 inches	8 or 12 inches	7 inches

dimensions & bed projection (bp): The space from the support wall that the mattress, panels or foundation projects into the room.

twin	45"w x 15"d x 85"h : 81"bp 45"w x 20"d x 85"h : 86"bp	–	79-1/2"w x 16"d x 82"h : 82"bp
twin long	45"w x 15"d x 90"h : 86"bp 45"w x 20"d x 90"h : 91"bp	–	–
full	60"w x 15"d x 85"h : 81"bp 60"w x 20"d x 85"h : 86"bp	69"w x 24-7/8"d x 85"h : 95"bp	94-1/2"w x 16"d x 82"h : 82"bp
queen	66"w x 15"d x 90"h : 86"bp 66"w x 20"d x 90"h : 91"bp	75"w x 24 7/8"d x 90"h : 95"bp	100-1/2"w x 16"d x 87" : 88"bp
king	84"w x 15"d x 90"h : 86"bp 84"w x 20"d x 90"h : 91"bp	88-1/2"w x 26"d x 90"h : 95"bp	–

murphy vs. panel

The **Murphy Bed** is a tried and true space saver. The spring loaded mechanism allows for easy single-handed operation and features a support leg that extends and retracts automatically. The Murphy bed's vertically stored mattress is either supported by our Comfort Flex Frame System (a series of pre-curved high strength wooden slats) or a Bunkie board (a cloth covered foundation). Each is designed to provide additional comfort and support for the mattress.

The **Panel Bed** maximizes space and offers a sleek, clutter-free design. These beds feature front panel doors that drop down with the bed and "disappear" under the mattress, allowing easy access to optional bedside cabinets. Each panel bed features one of two styles and includes spring loaded and cabinet-mounted bed mechanisms for effortless operation.



Dreamsaver Murphy Bed (open)



Metropolitan Panel Bed (pictured closed with optional side cabinets)



New Yorker (closed)



New Yorker (open)

panel beds

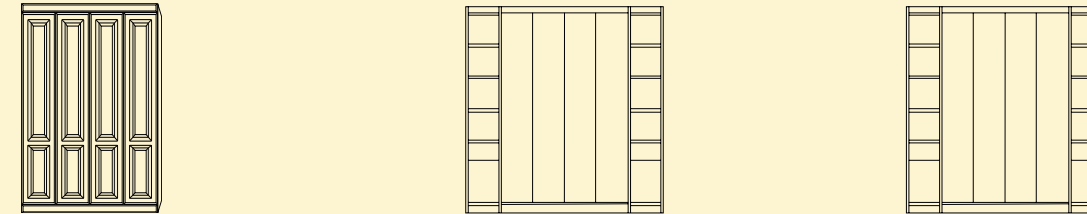

	metropolitan	manhattan	new yorker
	The panel bed saves even more space without the bi-fold doors. The panel drops down with the bed to become its mattress support.	Contemporary and sophisticated; this bed features built in drop-down nightstands and inset doors.	Strikingly contemporary, with 1-1/8" wide verticals and built in drop-down nightstands; a great statement in your space.
style	panel bed	panel bed	panel bed
doors	solid panel door	solid panel door	solid panel door
cabinets	side cabinets optional	16" side cabinets included	16" side cabinets included
mattress	8 or 12 inches	8 or 12 inches	8 or 12 inches

dimensions & bed projection (bp): The space from the support wall that the mattress, panels or foundation project into the room.

twin	44-1/2"w x 15 3/4"d x 85"h : 85"bp 44-1/2"w x 20 7/8"d x 85"h : 90"bp	76-1/8"w x 15-3/4"d x 83"h : 85"bp	77-5/8"w x 15-3/4"d x 83"h : 85"bp
twin long	44-1/2"w x 15 3/4"d x 90"h : 90"bp 44-1/2"w x 20 7/8"d x 90"h : 95"bp	76-1/8"w x 15-3/4"d x 90"h : 90"bp	77-5/8"w x 15-3/4"d x 90"h : 90"bp
full	59-1/2"w x 15 3/4"d x 85"h : 85"bp 59-1/2"w x 20 7/8"d x 85"h : 90"bp	91-1/8"w x 15-3/4"d x 85"h : 85"bp	92-5/8"w x 15-3/4"d x 85"h : 85"bp
queen	65-1/2"w x 15 3/4"d x 90"h : 90"bp 65-1/2"w x 20 7/8"d x 90"h : 95"bp	97-1/4"w x 15-3/4"d x 90"h : 90"bp	98-3/4"w x 15-3/4"d x 90"h : 90"bp
king	–	–	–

panel beds



Cosmopolitan panel bed. Shown open above and closed below.



Children's room (Open panel bed, pictured above)

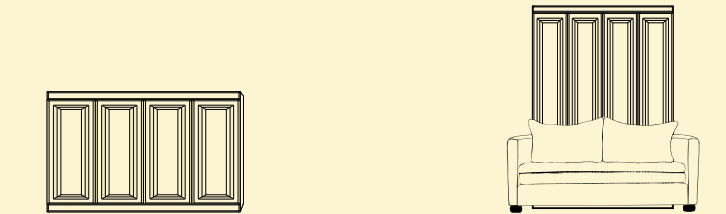

	cosmopolitan	chesterfield
	Whether you have a low ceiling or love the contemporary look, this horizontal panel bed is the perfect solution.	Extra seating converts easily to extra sleeping. Remove the cushions from this wall bed/sofa combo and the panel bed rests comfortably between the arms.
style	horizontal panel bed	metropolitan panel bed with sofa
doors	solid panel door	solid panel door
cabinets	side cabinets optional	side cabinets optional
mattress	8 inches	8 or 12 inches

dimensions & bed projection (bp): The space from the support wall that the mattress, panels or foundation projects into the room.

twin	80"w x 15 3/4"d x 49-1/4"h : 49"bp	–
twin long	85"w x 15 3/4"d x 49-1/4"h : 49"bp	–
full	80"w x 15 3/4"d x 64-1/2"h : 64"bp	59-1/2"w* x 15 3/4"d x 85"h : 85"bp 59-1/2"w* x 20 7/8"d x 85"h : 90"bp *Plus 8-12" for sofa arms
queen	85"w x 15 3/4"d x 70-1/2"h : 70"bp	65-1/2"w* x 15 3/4"d x 90"h : 90"bp 65-1/2"w* x 20 7/8"d x 90"h : 95"bp *Plus 8-12" for sofa arms
king	–	–

chesterfield options:

These modified, lower cabinet configurations are designed to accommodate the sofa arms while maximizing storage. Available in 24" or 30" wide cabinets. Choose from a wide selection of designer cloths, microsuedes and faux leathers.

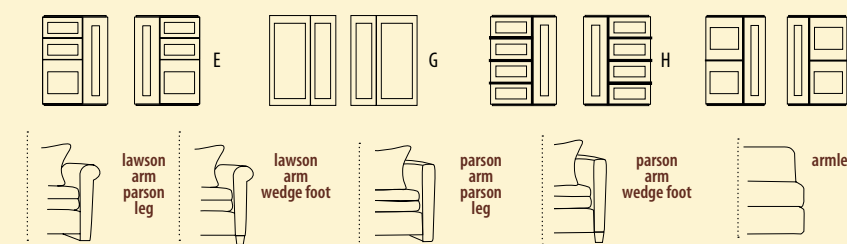

Chesterfield Panel Bed (pictured with optional side cabinets. Shown open above.)